



IKUSI
velatia

smartexperience

Power supplies “micro” APB series

Switch mode power supplies for mast amplifiers.
Smaller size with terrestrial and satellite inputs.

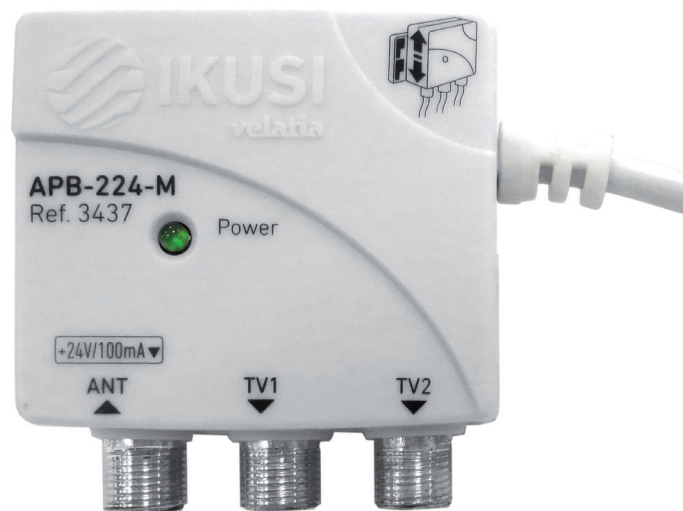
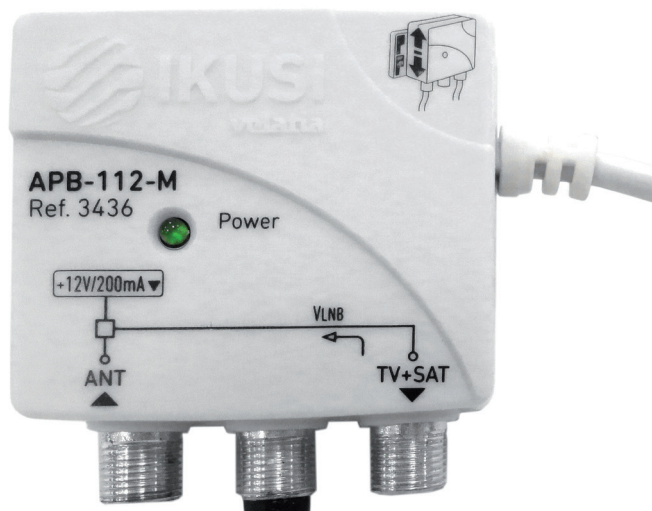

Optimum power consumption



Adaptable to standard boxes



Fastening without tools

APB power supplies

MODEL		APB-112-M
REF.		3436
EAN code		8435136434368
Regulation type		switch mode
Output		1
Mains voltage (50 Hz)	VAC	100 - 240
Output voltage	VDC	+12 (±5%)
Output voltage	mA	200
Frequency range	MHz	47 - 2400
RF insertion loss	dB	≤ 1.5
Current pass through	mA	300
Efficiency	%	>70
Dimensions	mm	50 x 50 x 25

MODEL		APB-224-M
REF.		3437
EAN code		8435136434375
Regulation type		switch mode
Outputs		2
Mains voltage (50 Hz)	VAC	100 - 240
Output voltage	VDC	+24 (±5%)
Output voltage	mA	100
Frequency range	MHz	47 - 862
RF insertion loss	dB	≤ 4
Efficiency	%	>70
Dimensions	mm	50 x 50 x 25

APB-112-M Application example

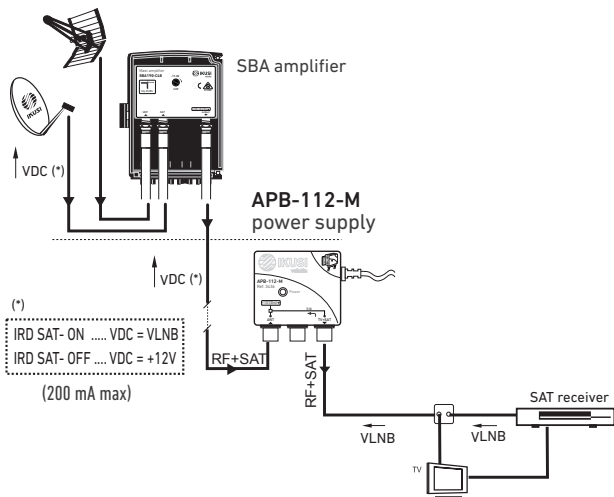

How the APB-112-M works

When the user's SAT receiver is OFF or stand-by, the APB-112-M power supply operates normally, providing +12V voltage for the mast-head preamplifier (and also, attention, for the attached LNB). When the SAT receiver is switched ON, the APB-112-M comes automatically to stand-by and let pass the voltage/tone signals from the receiver, so that the LNB as well as the SBA190 preamplifier are powered by the SAT receiver.

- The smallest on the market.
- It allows installation in any junction box.
- Optimum power consumption. Low power switch mode.
- Mounting without tools.
- 1RF input connector + DC output port / 1 or 2 RF outputs ports.

APB-224-M Application example

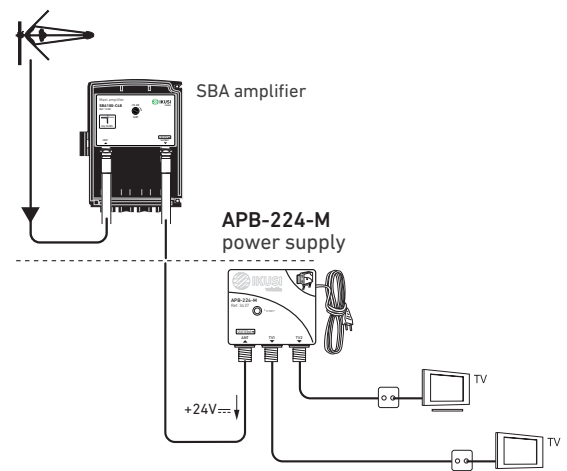

Wall fixing system

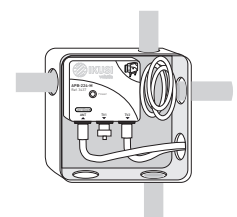
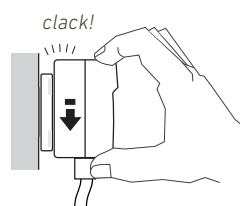
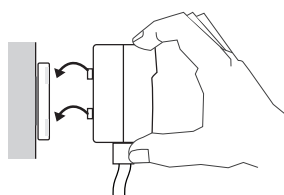
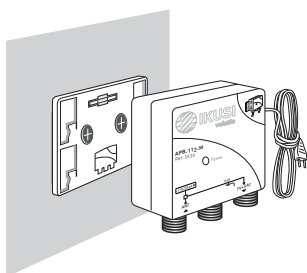

Adaptable to standard boxes
80x80 mm