



Certificado CE : <https://www.ikusi.tv/es/productos/szb-214>
 CE Marking : <https://www.ikusi.tv/en/products/szb-214>
 Certificate CE : <https://www.ikusi.tv/fr/products/szb-214>



SZB-214 FUENTE DE ALIMENTACIÓN DE LA ESTACIÓN DE CABECERA SZB

Ref. 2250 POWER SUPPLY OF SZB HEADEND

ALIMENTATION DE STATION DE TÊTE SZB

Modelo / Model / Modèle	SZB-214	
Ref.	2250	
Tensión de red / Mains voltage / Tension secteur	VAC	100 - 240 (50/60 Hz)
	W	120
Tensión de salida / Output voltage / Tension de sortie	VDC	+24
Corriente máx. de salida / Max. output current / Courant max. de sortie	A	4,5
Tª funcionamiento / Operating temperature / Température fonctionnement	°C	-10 ... +55
Índice de protección / Protection level / Niveau de protection	IP	IP20

Montaje en la base
 Fitting from the base-plate
 Montage sur la platine

Desmontaje en la base
 Removing from the base-plate
 Démontage sur la platine

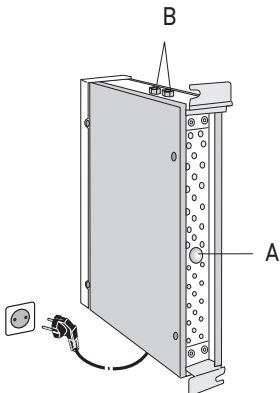
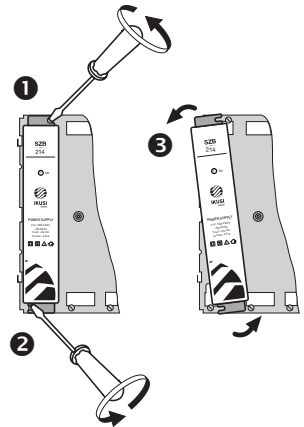
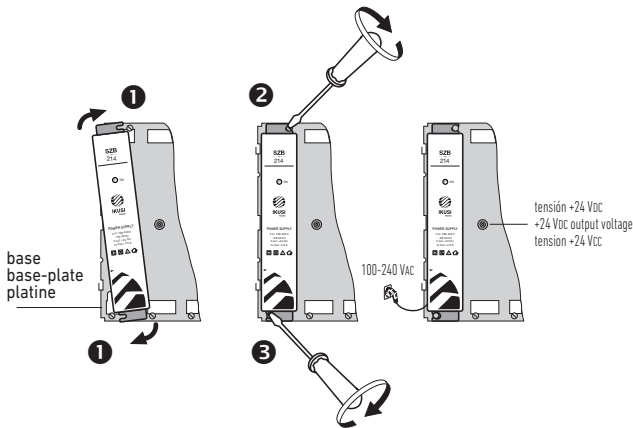

• La tensión +24 VDC de salida se dispone en el borne circular A de la base del módulo, así como en cada una de las dos hembra B del lateral superior.

NOTE: La fuente de alimentación SZB-214 tiene característica soft-start: tras la conexión red alterna, la tensión de salida +24 VDC no está disponible hasta después de 7 segundos.

• The +24 VDC output voltage is available at the circular terminal A on the base of the module, as well as at each one of the two banana sockets B on the upper side.

NOTE: The power supply SZB-214 features soft-start: after mains connection, the +24 VDC output voltage is not available until 7 seconds later.

• La tension +24 VCC de sortie est disponible sur la borne circulaire A de la base du module, ainsi que sur chacun des deux embases banane B au côté supérieur.

NOTE: L'alimentation SZB-214 a caractéristique soft-start : après le raccordement secteur, la tension de sortie +24 VCC n'est pas délivrée avant d'avoir passé 7 secondes.

EC-Declaration of Conformity



We, Manufacturer

Ikusi Electrónica S.L.
Paseo Miramón, 170
20014 San Sebastián, Spain

declare that the product

Power Supply
SZB-214 (2250)

are in conformity with

Council Directive 2014/53/EU

Standards to which conformity is declared :

are in conformity with

RoHS 2. Directive 2011/65/EU

Standards to which conformity is declared :

EN 50083-2:2012+A1:2015

Cable networks for television signals, sound signals and interactive services. Part 2: Electromagnetic compatibility for equipment.

EN 61000-3-2:2014

Electromagnetic compatibility (EMC) - Part 3-2: Limits - Limits for harmonic current emissions (equipment input current up to and including 16 A per phase).

EN 61000-3-3:2013

Electromagnetic compatibility (EMC) - Part 3-3: Limits - Limitation of voltage changes, voltage fluctuations and flicker in public low-voltage supply systems, for equipment with rated current up to 16 A per phase and not subject to conditional connection.

EN 62368-1:2014

Audio/video, information and communication technology equipment - Part 1: Safety requirements (LVD) (Endorsed by AENOR in September of 2014).

UNE-EN 50581:2012

Technical documentation for the assessment of electrical and electronic products with respect to the restriction of hazardous substances (RoHS) (Endorsed by AENOR in November of 2012)



San Sebastián, October 2019

Jesús Gómez Río

— R&D Director —