

Optical fiber cleaver user manual

Warning

- Please read this manual before operation.
- Please collect fiber scarp with the specified container to prevent them into skin and eyes.
- Do not touch the blade.
- Do not disassemble or lubricate, please contact with the service department of maintenance.
- Please gently to use, any bump that may affect the cutting quality.
- Store it in a dry, clean place with the protective box.

Specification

Applying Fiber	Silica Optical Fiber (Special fixture is required when cutting ribbon fiber)
Fiber Type	φ0.25/φ0.9/φ3.0/3.0*2.0mm
Coating Diameter	125μm
Cleaved Length	9-24mm
Dimensions	85(W)×75(D)×45(H)mm
Weight	≈205g
Cleaved Angle	≤0.6°
Blade life	48,000 times
Blade Type	Outer diameter 20.0, inner hole 4.0, thickness 2.0mm

Structure

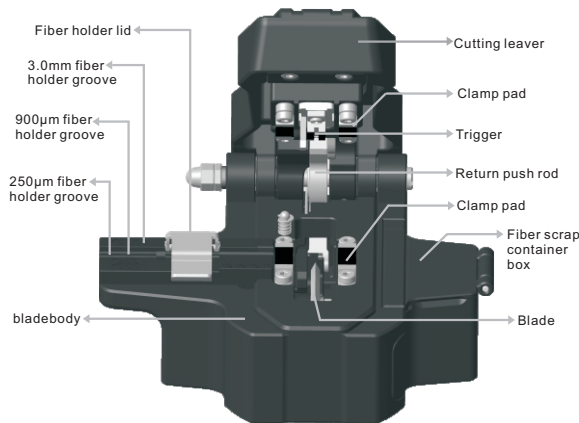

Operation



Figure1



Figure2



- Press the platen tightly, turn the lock to "on" (Fig. 1), and lift it.
- Open the cutting lever (Fig. 3). Place the fiber in the slot, aligning the coating boundary with the desired length mark (e.g., 16mm). Ensure the bare fiber is straight. Cover and clamp the fiber.
- Press the cutting lever to cut the fiber (Fig. 4).
- Release the cutting lever, hold the fiber, open the fiber holder lip, remove the fiber, and clean debris. The blade resets for the next cut (Fig. 5).
- To store, clean waste fibers, press the cover, lock the switch to OFF (Fig. 2), and place in the box.

Daily Using and Maintenance

- When using the cleaver, you must ensure that the clamp pad and the fiber holder guider groove are clean and free of dust and impurities.
- Always clean the fiber at the front end of the slider (Remove the side panel and clean it with a brush), otherwise it may failure of the cleaver.

Change the angle of blade:

If cleaving quality descends (usually cleave 1000 to 2000 times), the blade may be worn. Please follow the step to adjust the blade angle:

- ※ First, press the cutting lever, turn the switch to ON, and open it (Fig. 1).
- ※ Remove the fiber scrap container box's 2 screws with a 1.5mm hex driver.
- ※ Loosen screw C with the same driver, hold the blade with a cotton swab, and rotate it to the desired position (Fig. 7).
- ※ Tighten screw C.
- ※ Cut the fiber twice, then check the end face using the splicer screen. (See "Blade Height Adjustment").

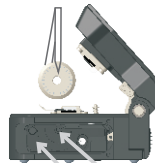
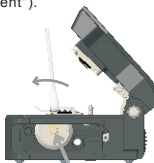
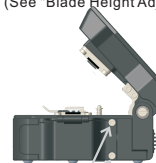

Figure6

Figure7

Figure8

Notice

- Avoid touching the blade with fingers when changing position.
- Do not use metal tools to rotate the blade, as it may damage it.

Blade replacement:

- Replace blade if cutting quality doesn't improve after adjusting position and height.
- Remove 2 screws C from fiber scrap container box (Fig. 6) and detach it.
- Unscrew Blade screw C, use rubber tweezers to remove blade (Fig. 8).
- Install new blade with "1" facing up, slide into groove, and insert middle hole into guide on pillar.
- Tighten Blade screw C.

Notice:

- The blade is precisely ground and will be damaged if it touches metal, losing performance. Handle with care.
- Avoid damaging the cutting edge when using metal tweezers.
- Wear gloves when handling the blade; do not touch it directly with your hands. Dispose of the replaced old blade separately from ordinary garbage

Adjusting the height of blade:

- Loosen the screw A. (Fig. 10)
- Adjust the blade height by adjust the screw B to a suitable height.
- Tighten the screw A.

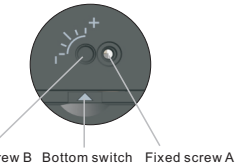
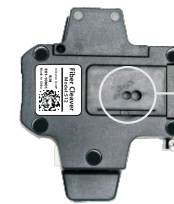

Figure10

Notice:

- Loosen screw A and turn screw B clockwise to raise blade height.
- Loosen screw A and turn screw B counterclockwise to lower blade height.

Conventional issues and solution

The phenomenon of issues	Conventional issues and solutions
Fiber cannot be cut though	1. If the clamp pad abrasive wear or aging please replace them. 2. Elevate the height of blade 3. Clean the blade edge
The end face has fillet	1. Lower the height of blade 2. If the clamp pad abrasive wear or aging please replace them.

- If the fiber cleaver adjusted according to the above method still has cutting quality problems even with a new blade, please contact the after-sales department.
- If there are machine problems such as the slider not running smoothly, the rubber presser foot is not closed tightly, or the striker is blocked, please contact the after-sales service.

Product List

Name	Quantity
Fiber cleaver	1
1.5mm hexagon wrench	1
Manual	1