

# 4G/LTE FILTER KIT

Channel 59

Part No. 314080

## SPECIFICATION

Frequency (MHz)	5-782
Insertion Loss (@ 782 MHz)	<4dB
Rejection (@ 821 MHz)	>25dB
Power Pass	12V / 300mA
Connections	IEC (female) - IEC (Male)



LET'S BE **at** CLEAR **800**™

## BOX CONTENTS

1 x Triax 4G/LTE Filter



1 x 160mm Lead IEC (male) - IEC (female) 'A'

1 x Velcro strip

1 x Instruction Leaflet

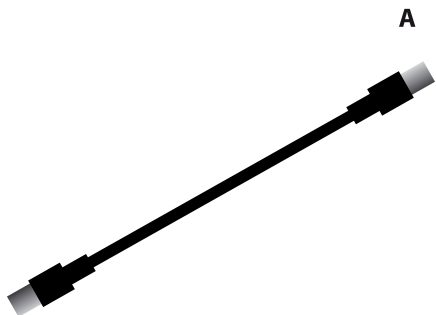

## INSTALLATION GUIDE

1. Turn off TV at the mains electrical socket
2. Remove the fly lead from the aerial socket on the rear of the TV
3. Plug the fly lead (previously attached to the TV) in to port 'B' on the filter



# 4G/LTE FILTER KIT

## Channel 59

Part No. 314080

### INSTALLATION GUIDE CONT.

4. Plug the IEC (female) 'A' end of the fly lead in to port 'A' on the filter.
5. Plug the other end of the fly lead with the IEC (male) connector into the TV aerial socket.
6. If required, the Triax 4G/LTE Filter can be fixed to the rear of the TV with the velcro strip supplied.
7. Turn on the TV at the mains electrical socket and switch on TV.



LET'S BE at CLEAR 800™

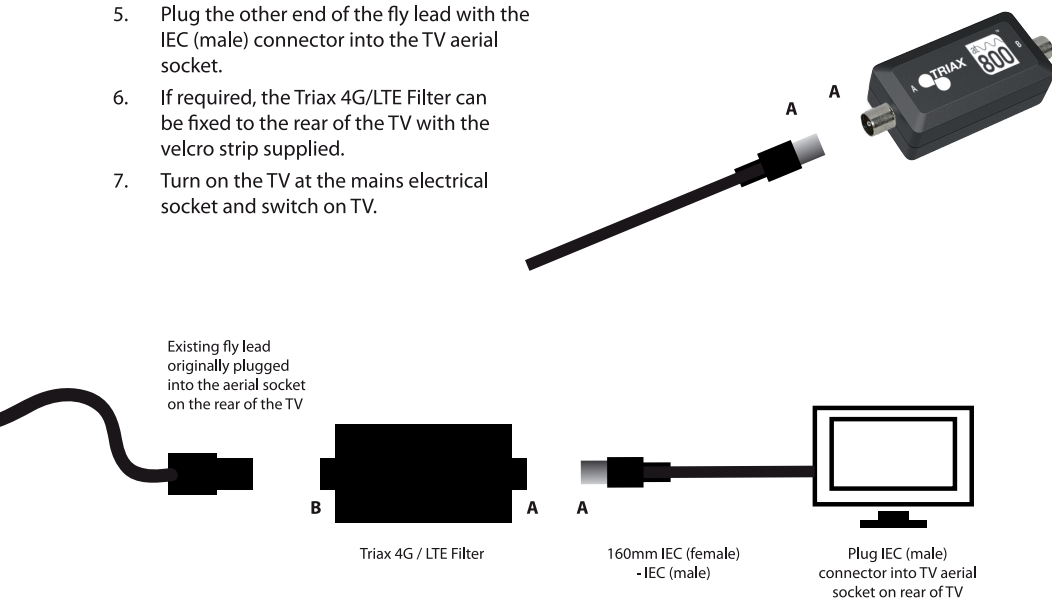

LTE Technology operates in the 790-862MHz frequency range and may cause problems for installed Digital Terrestrial Television which historically has been developed to operate within these frequencies.

Products carrying the 'LTE Protected by Triax' logo meet our strict requirements of attenuation above channel 59.

"Let's be clear at 800" is a trademark owned by Digital Mobile Spectrum Limited.

The "AT 800" logo is a registered trade mark used under licence from Digital Mobile Spectrum Limited.

### GUARANTEE

Your Triax purchase is guaranteed against faulty components and workmanship for 1 year. This excludes any failure caused by improper use, accidental or malicious damage.

Helpline: 01443 778 910  
(Normal operator charges apply)



[www.comcast.com](http://www.comcast.com)